

Sailfish 220 WAC Owner's Manual



07/13/2020

 **SAILFISH**
B O A T S



Table of Contents



07/13/2020

- | | |
|--|--|
| 2. Boat Specification | 21. Plug and Play Wiring |
| 3. Sailfish Boats Trailer Measurement Chart | 21. Fuel-Water Separator - Yamaha |
| 4. Boat Layout | 22. Console / Head Area |
| 5. Seating Locations | 23. Bilge Access and Explanation |
| 6. Boat Safety & Warning Labels | 24. Bilge Pumps |
| 8. Boat Safety & Warning Label Locations | 25. Raw Water Washdown System |
| 10. Boarding Ladder & Unassisted Boarding Situations | 26. Freshwater Washdown and Shower System |
| 11. Breaker Panel Schematic | 27. Livewell Operation |
| 12. Switch Panel Schematic | 28. Trim Tab Maintenance |
| 13. Distribution Harness | 29. Optional Porta Potti |
| 14. Adapter Harness | 31. Vinyl Care and Cleaning |
| 15. Battery Installation - Perko Switch | 32. Aluminum Cosmetic Corrosion (Pitting) |
| 16. Fuel System Layout | 33. Caring for Aluminum |
| 17. Plumbing Diagram | 34. Caring for Stainless Steel |
| 18. Helm Area | 35. Windshield, Window and Hatch Care Instructions |
| 19. UFLEX Steering System | 36. Gel Coat |
| 20. Ignition Switches, Engine Shut-Off Cord/ Lanyard | |

Sailfish 220 WAC Specifications



07/13/2020



SPECIFICATIONS

LOA Hull Only	21' 3"
Length Rigged	23' 6"
Beam	8' 6"
Fuel Capacity	93 Gallons
Fresh Water	6 Gallons
Weight	4,950 lbs.
Cockpit Depth Rear	26"
Max Horsepower Single	200 hp
Draft (Hull Only)	18"
Dead Rise (Multiangle)	22°-24°
Battery Capacity	2
Rod Holders (Standard)	8
Bridge Clearance with Top	8' 4"
Person Capacity	8

STANDARD FEATURES

Boat

- Boarding Ladder (3 step)
- Built In Rigging Tubes (From Bilge to Helm with pull tapes)
- Carbon Fiber & Kevlar® Reinforced Deck & Hull
- Closed Cell Foam Flotation
- Cockpit Bolster Pads
- Exclusive Dot Matrix Non-Skid Flooring
- Exclusive VDS Hull Design (Variable Deadrise Stepped Hull)
- Faucet at Sink (Cabin)
- Hydraulic Steering w/ Tilt SST Steering Wheel w/ Power Knob
- Mercury Verado Fuel Filter / Water Separator
- Recessed SST Cup Holders (5)
- SailTech Composite Full Length Transom
- SailTech Foam Filled Fiberglass Stringer System
- Trim Tabs w/ Indicator & Built In Auto Retract Feature
- Walk Thru Transom Door with Wave Guard Step
- Yamaha 10 Micron Fuel Filter / Water Separator w/ SST Base

Cabin Amenities

- Cabin 25Qt. Cooler

- Cabin Butane Stove / Sink / Freshwater / Table
- Cabin V-Berth Cushions and Filler Cushions
- Mirror

Electrical

- 12 Volt DC Accessory Plug
- Accessory Switch Panel w/Circuit Breakers
- Cabin Lighting
- Compass
- Dual Battery Switch
- Electric Horn
- Full Digital Instrumentation
- Fully NEMA Compliant
- Fusion/Wet Sounds Stereo System & USB Port
- LED Interior Cockpit & Bilge Lighting
- LED Navigational Bow & Anchor Light
- Remote Control For Stereo at Helm

Fishing

- Baitwell w/ LED Lighting 25 gal. Transom
- Built-In Tackle Storage (Aft Under Transom Door)
- Insulated Fish Box / Storage (Leaning Post)

Hardware

- Boarding Ladder (3 step)
- Fender Cleats (4)
- Flush Mount Hinges, Latches & Deck Plates
- Heavy Duty SST Bow & Stern Eyes
- Heavy Duty SST Rub Rail
- Marine Grade SST Hardware
- Sailfish Engraved Transom Plate
- SST & Bronze Thru Hull Fittings
- SST Flush Mount Pull Up Cleats
- SST Full Bow Rail
- SST Propeller
- SST Rod Holders (4)

Helm

- Large Dash Area (Capable of flush mounting 10" Screen)

Plumbing

- Automatic Bilge Pump (2000 GPH)
- Freshwater Shower (2) - Transom and Cabin
- High Speed Live well Pickup
- Porta Potti
- Raw Water Washdown
- Self Bailing Cockpit
- Sink w/ Faucet (In Cabin)

Storage

- Anchor Locker (w/ Bow Roller)
- Battery Storage (Bilge Compartment)
- Recessed Rod Storage (Port & Starboard)

Seating

- Leaning Post (LP 4) Fiberglass w/Fish Box & Cooler

OPTIONS

Boat Options

- 25 qt. Igloo Coolers (Pair)
- CL7 (C Series Motors Only)
- Leaning Post Cover
- Underwater LED Lights (2)

Electrical Options

- Built-In 2 Bank Battery Charger
- Built-in Solar Battery Charger (Hard Top Only)
- Garmin B60 Airmar Thru Hull Transducer w/o CHIRP
- Garmin B75M Airmar Thru Hull Transducer w/ CHIRP
- Garmin GPSMap 742xs w/o Transducer
- Garmin Radar Cable & Power Cable
- Remote Spot Light for Hard Top
- Garmin 215 VHF Radio & Antenna
- Wet Sounds LED Lighted Speakers Upgrade

Hardware Options

- Ski Tow Bar (Retractable)

Seating Options

- Rear Jump Seats

Optional Packages

- Offshore Tournament Pack
Hard Top, Powder Coated w/ Built-In Radio Box & Transom Rod Holders

Engine Options

Yamaha

- F150XB
- F150XCA
- F200XB
- F200XCA

Mercury

- 150XL
- 200XL DTS
- Single Mercury White Motor Upgrade (Only Available on 200HP)

SAILFISH BOAT TRAILER MEASUREMENT CHART:

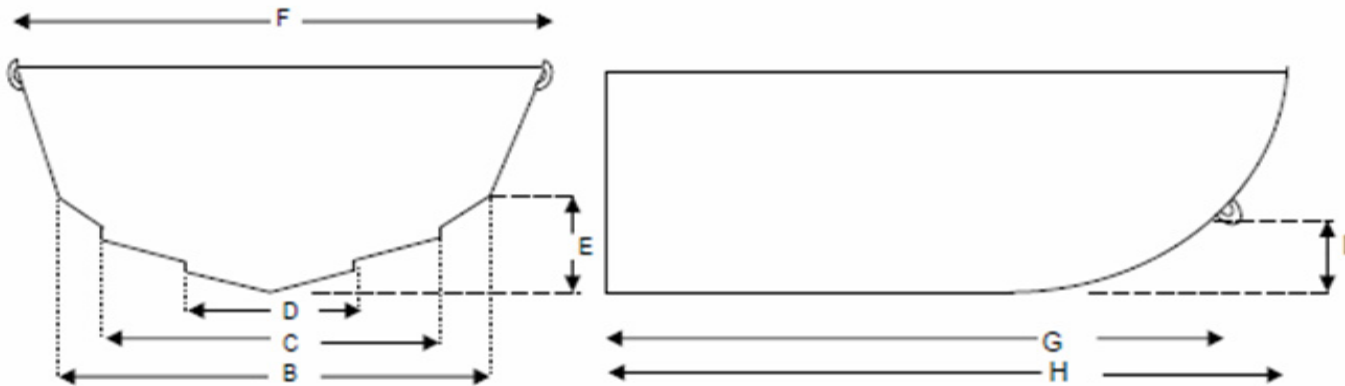

Boat Models	B	C	D	E	F	G	H	I
208CC	78 in.	53 in.	28 in.	11 in.	82 in.	218 in.	235 in.	27 in.
1900BB	88 in.	66 in.	37 in.	10.5 in.	99.5 in.	198 in.	217 in.	24 in.
2100BB	88 in.	66 in.	37 in.	10.5 in.	99.5 in.	220 in.	240 in.	24 in.
220CC & 220WAC	87 in.	59 in.	31 in.	14.5 in.	102.5 in.	216.5 in.	243 in.	32 in.
236CC & 241CC & 245DC	91 in.	57.5 in.	30 in.	14 in.	103 in.	250 in.	273 in.	36 in.
240CC & 240WAC & 242CC	92 in.	59 in.	31 in.	15 in.	107 in.	241 in.	272 in.	30 in.
270CC & 270WAC	94 in.	59 in.	31 in.	15 in.	107 in.	268 in.	302 in.	30 in.
272CC & 276DC	93 in.	61 in.	32 in.	15 in.	109 in.	287 in.	321.5 in.	38 in.
275DC	94 in.	59 in.	31 in.	15 in.	107 in.	268 in.	302 in.	30 in.
290CC	94.5 in.	61 in.	32 in.	15.5 in.	107 in.	301 in.	336 in.	30 in.
320CC & 320EXP & 325DC	105 in.	65 in.	33 in.	16.5 in.	115 in.	315 in.	349 in.	38 in.
360CC	119 in.	72 in.	36 in.	20.1 in.	135 in.	383.34 in.	417.5 in.	48.19 in.

Sailfish 220 WAC Boat Layout



07/13/2020

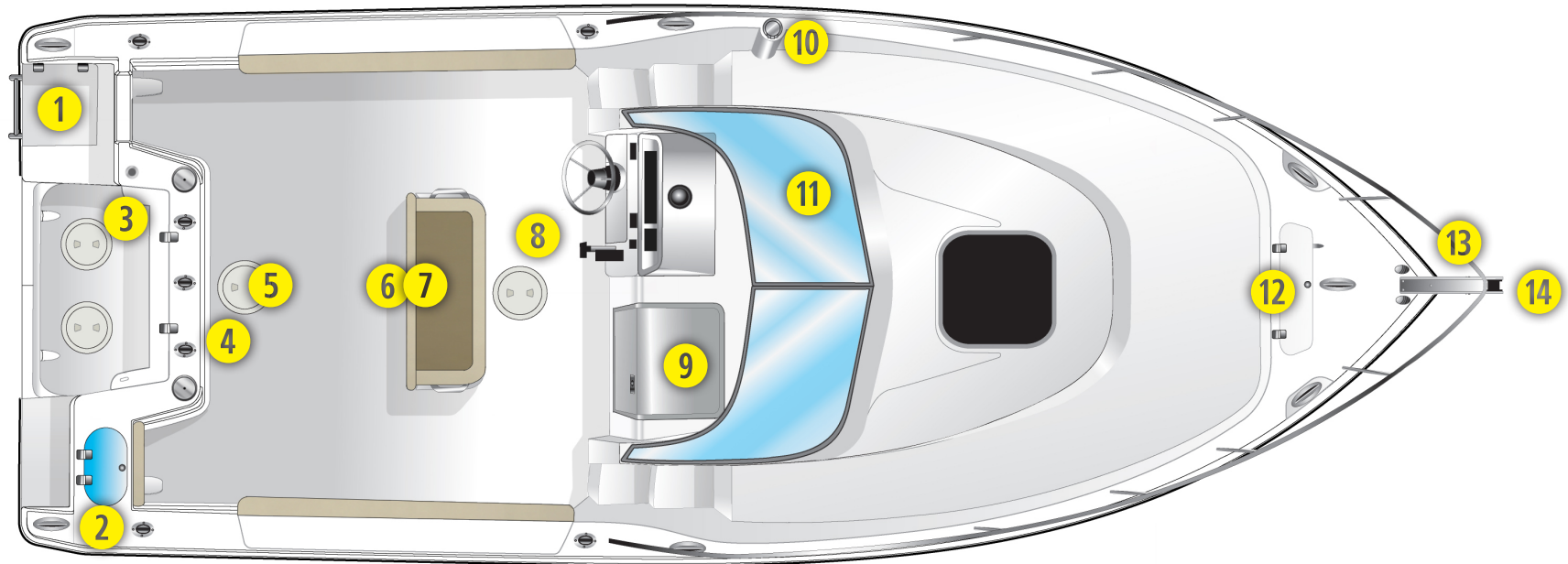

Key	Description
1	Boarding Ladder
2	30 Gallon Livewell
3	Fresh Water Fill
4	Bilge Access
5	Fuel Sender and Pick-up Access
6	Removable Cooler
7	Leaning Post

Key	Description
8	Helm Area
9	Cabin Door
10	Fuel Fill
11	Full Wraparound Windshield
12	Anchor Locker
13	Full Bow Rail
14	Anchor Roller

Sailfish 220 WAC Seating Locations



07/13/2020

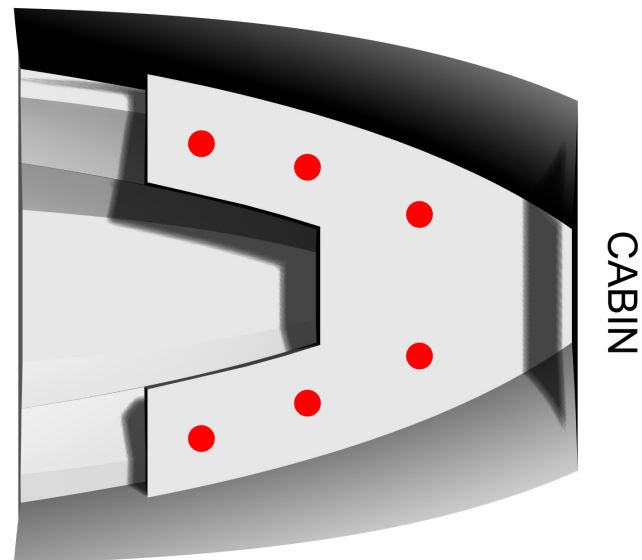
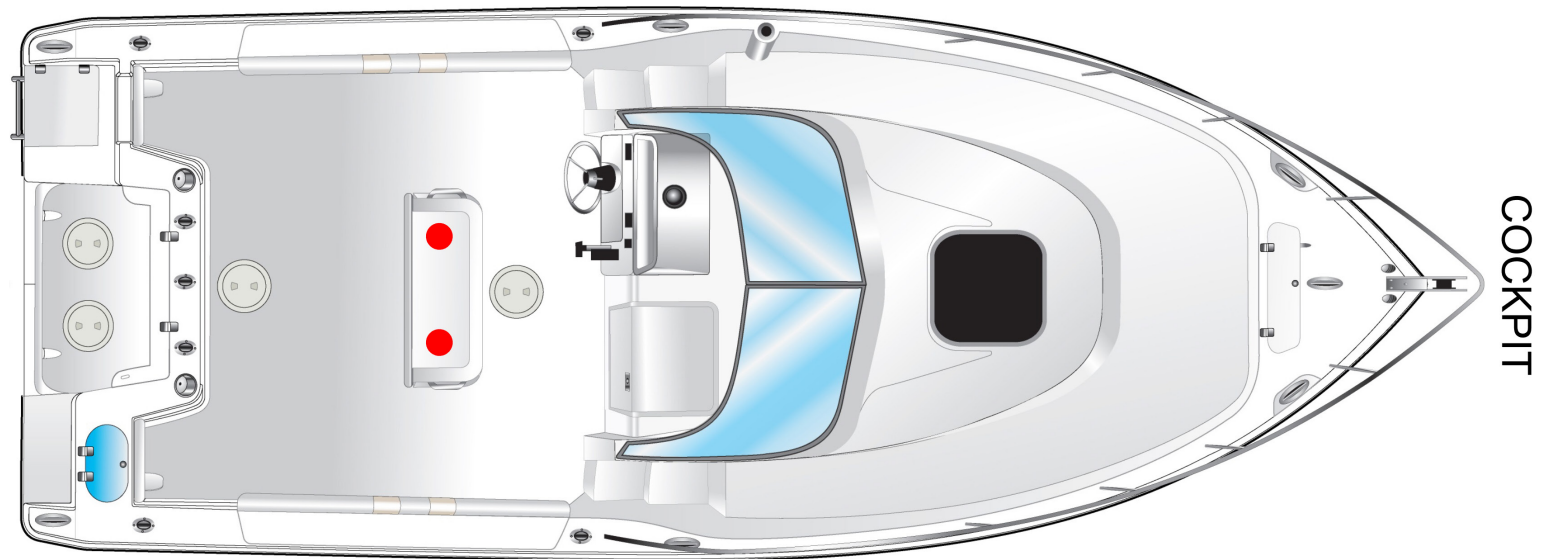

Boat Safety & Warning Labels



07/13/2020

Warning Labels

The safety for you and everyone on board, as a boat owner, you need to become familiar with and the locations of the Caution, Warning and Danger Labels found on your boat.

Below are images of the labels to help you maintain and operate your boat safely.

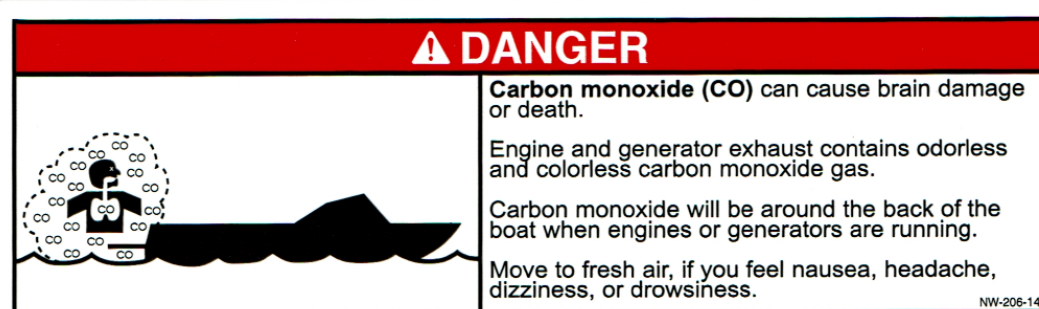
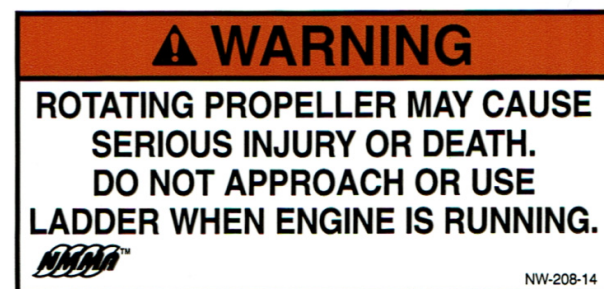
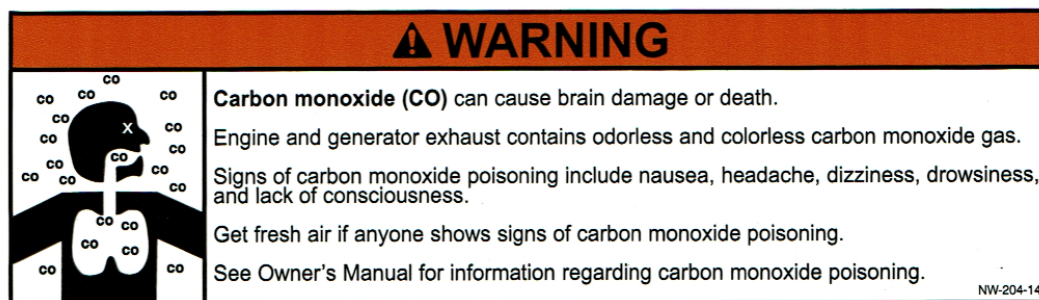
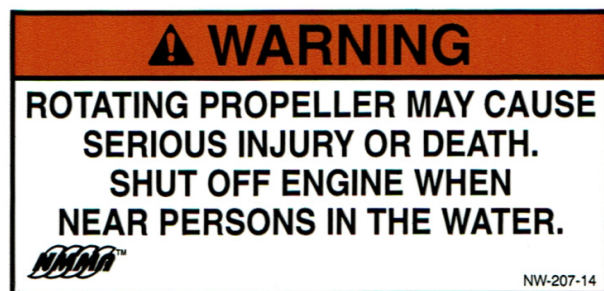

Boat Safety & Warning Labels



07/13/2020

Warning Labels Continued

The safety for you and everyone on board, as a boat owner, you need to become familiar with and the locations of the Caution, Warning and Danger Labels found on your boat.

Below are images of the labels to help you maintain and operate your boat safely.

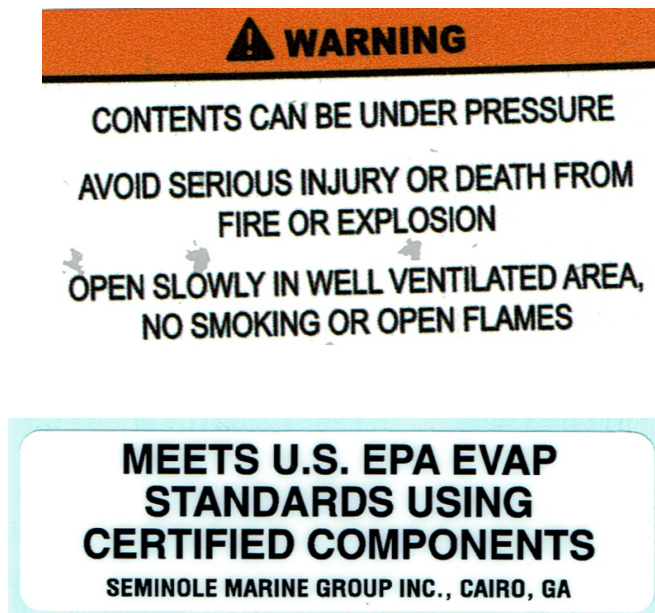

Boat Safety & Warning Label Locations



07/13/2020

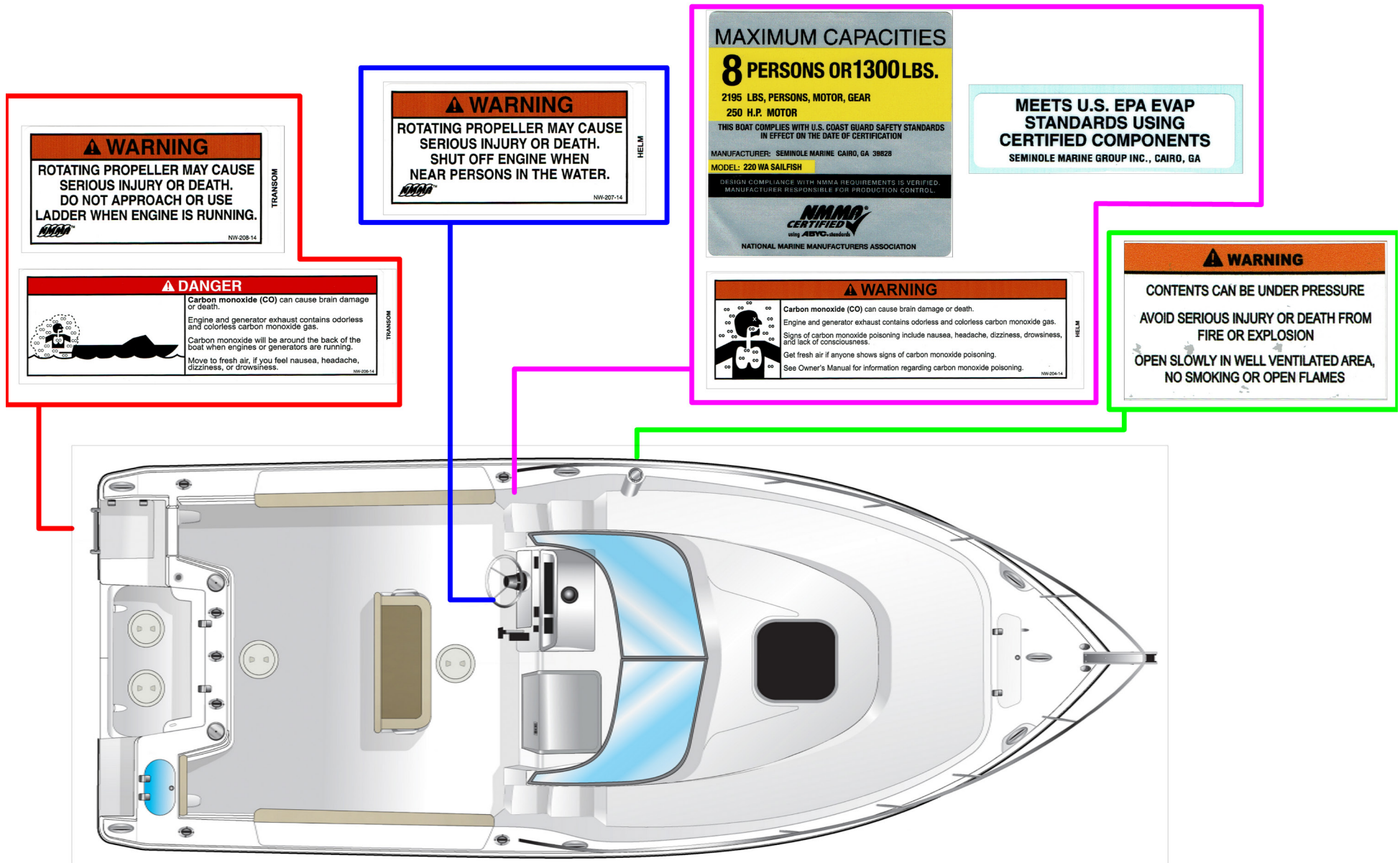



Replacement Warning Labels

If any of your Boating Safety or Warning Labels become damaged, please call Sailfish Boats' parts department for replacement stickers at 229-377-2125



SAILFISH

FISHING FOCUSED. FAMILY FRIENDLY.™

Boarding Ladder & Unassisted Boarding Situations



07/13/2020

Unassisted Boarding Instruction

When using the ladder in an unassisted boarding situation, reach over the transom and open the covering board lid that is covering the ladder, pull ladder towards you, by picking up the ladder by the steps, release the strap, deploy the four step ladder by rotating it to the down position. Use your hand or foot to fully extend the ladder in the down position. Use the grab handle and ladder to board your boat. When fully onboard, be sure to place the ladder back in the storage position by reversing the deployment process.

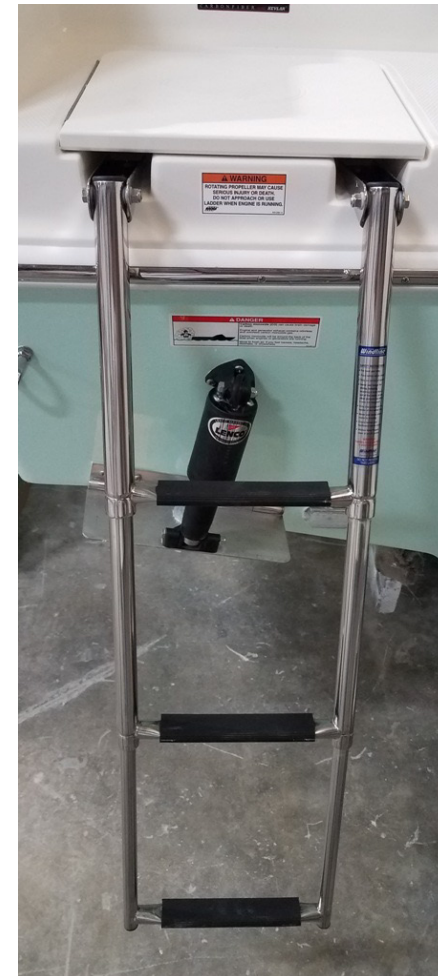

Breaker Panel Schematic



07/13/2020

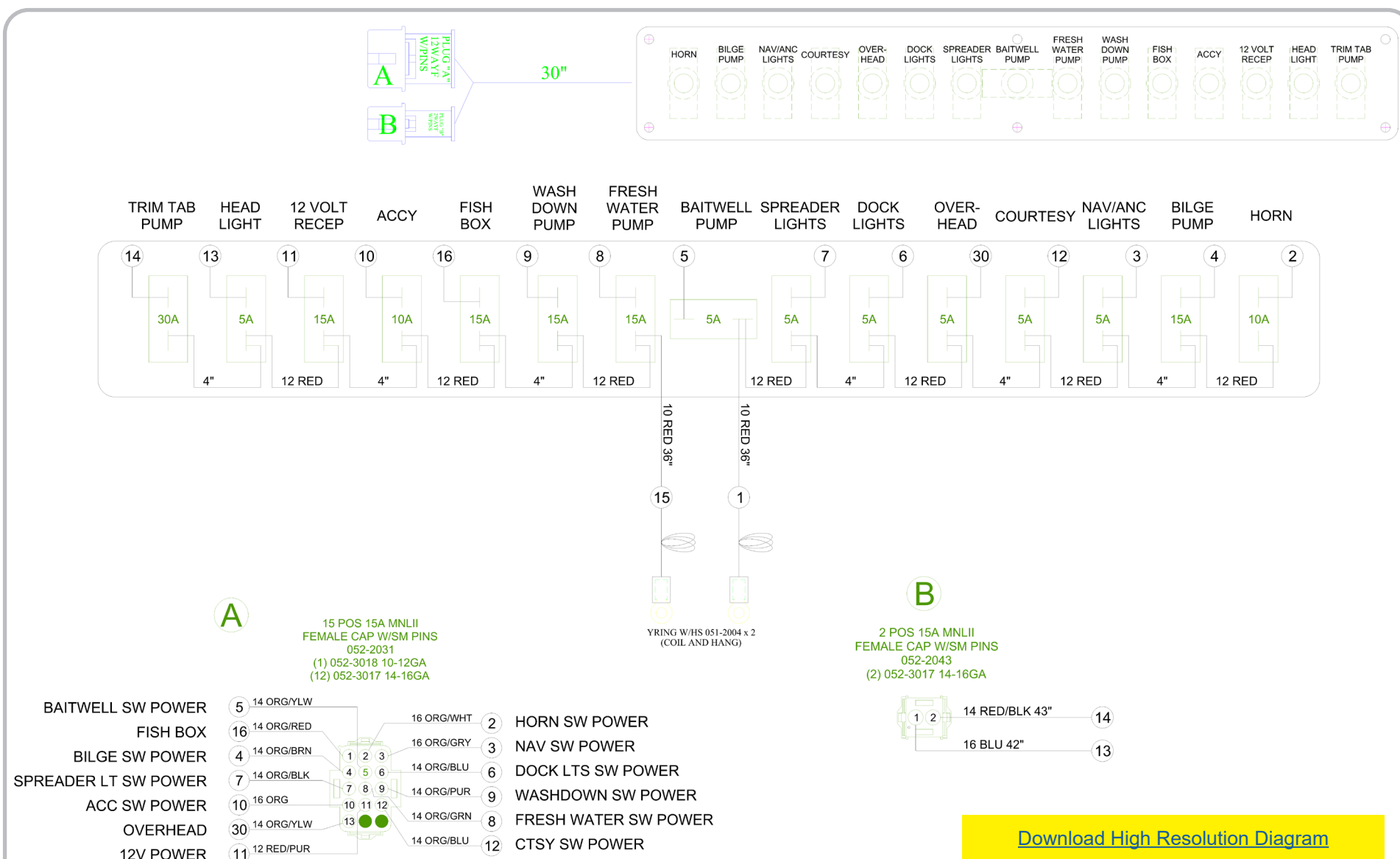

Switch Panel Schematic



07/13/2020

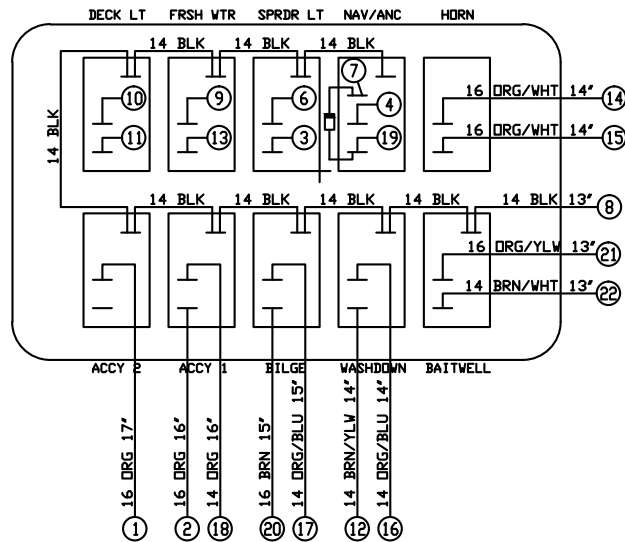

(A)
12 POS 15A MNLII
FEMALE CAP W/SM PINS
052-2035
(11) 052-3017 14-16GA

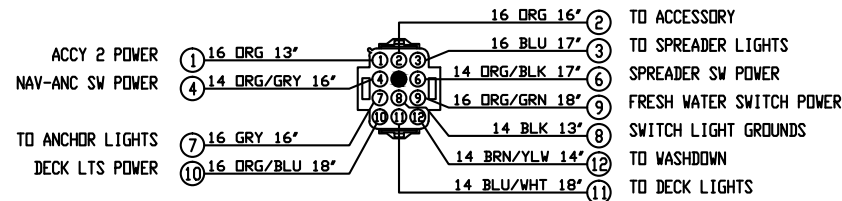

(B)
12 POS 15A MNLII
FEMALE CAP W/SM PINS
052-2035
(10) 052-3017 14-16GA

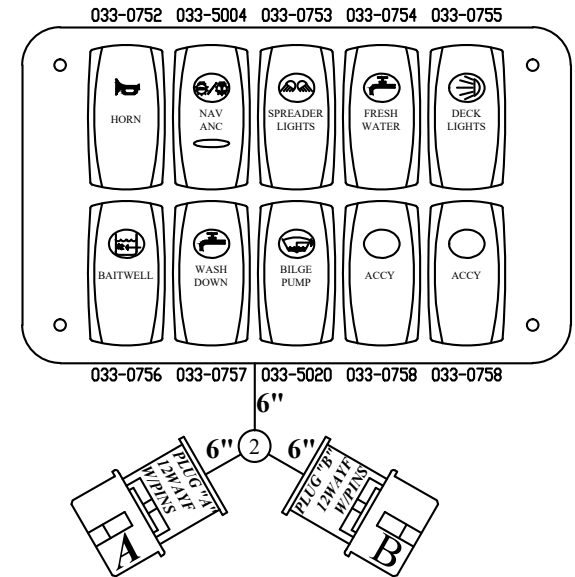
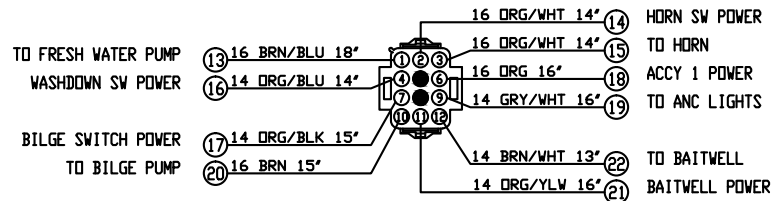

[Download High Resolution Diagram](#)

Distribution Harness

07/13/2020

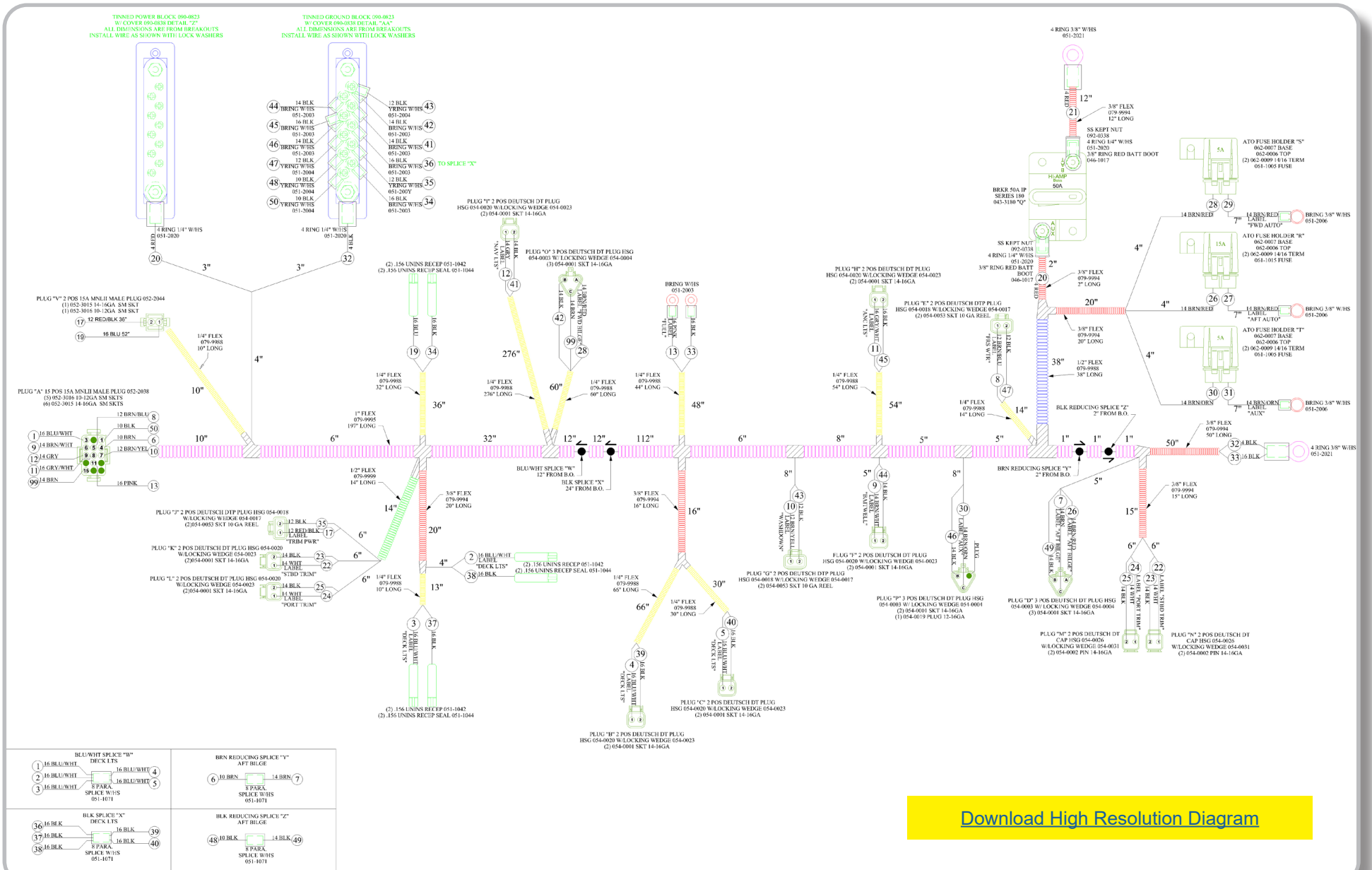

Adapter Harness



07/13/2020

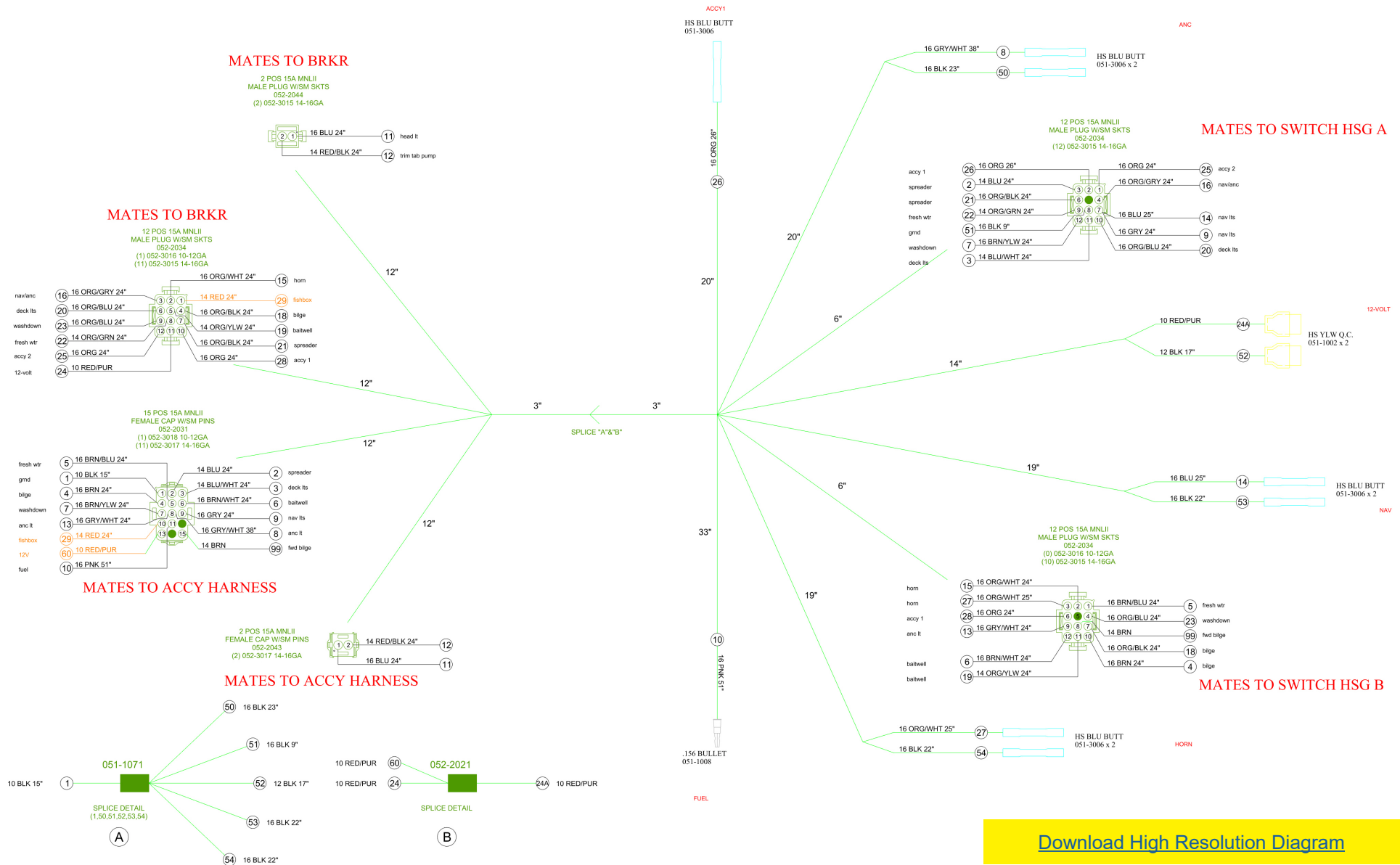

Battery Installation: Perko Switch



07/13/2020

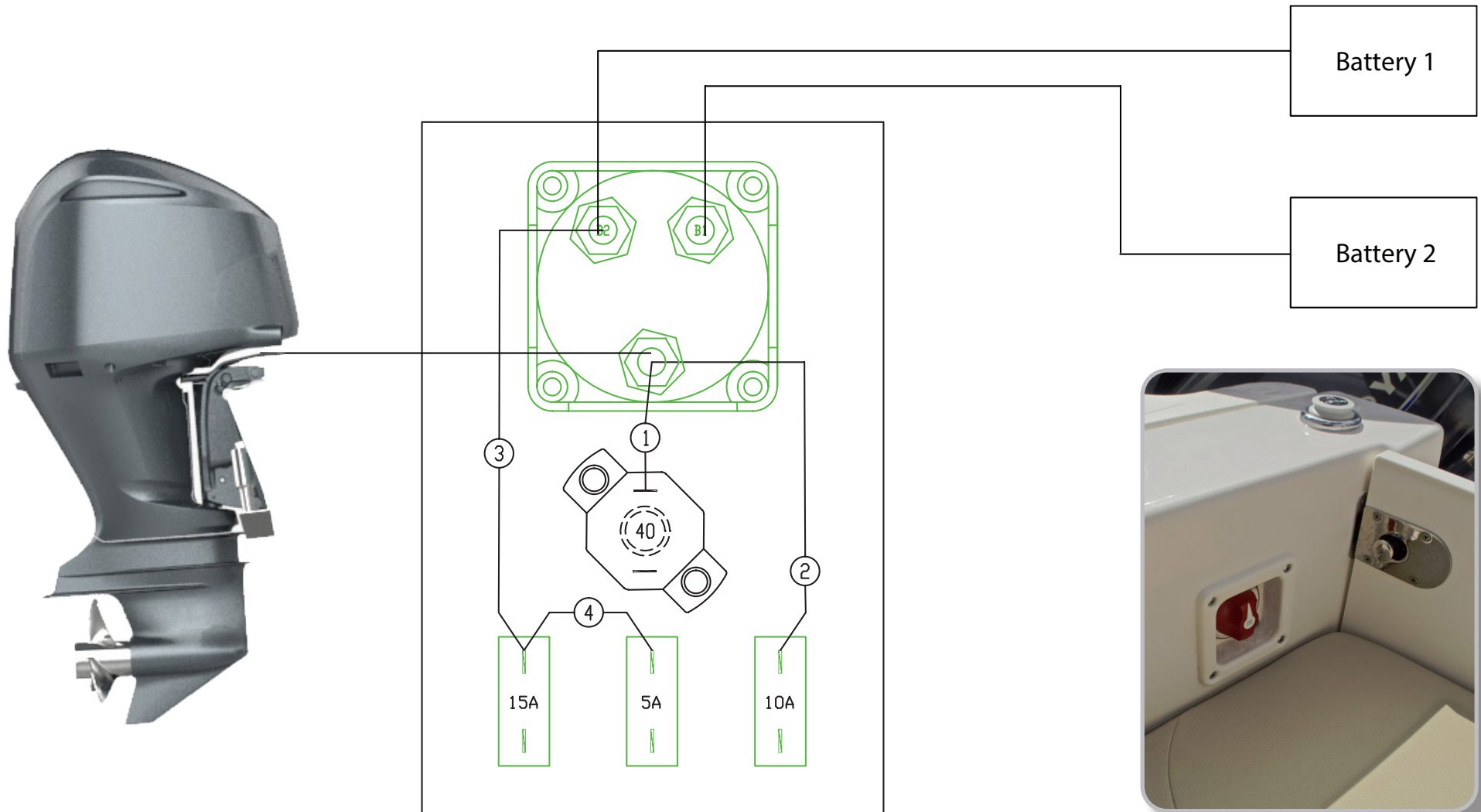

Fuel System Layout



07/13/2020



Key	Description
1	Primer Bulb - N/A on Verado
2	Fuel Filter Access - Yamaha & Verado Only
3	Fuel Tank Location
4	Fuel Pickup
5	Fuel Sender
6	Fuel Fill

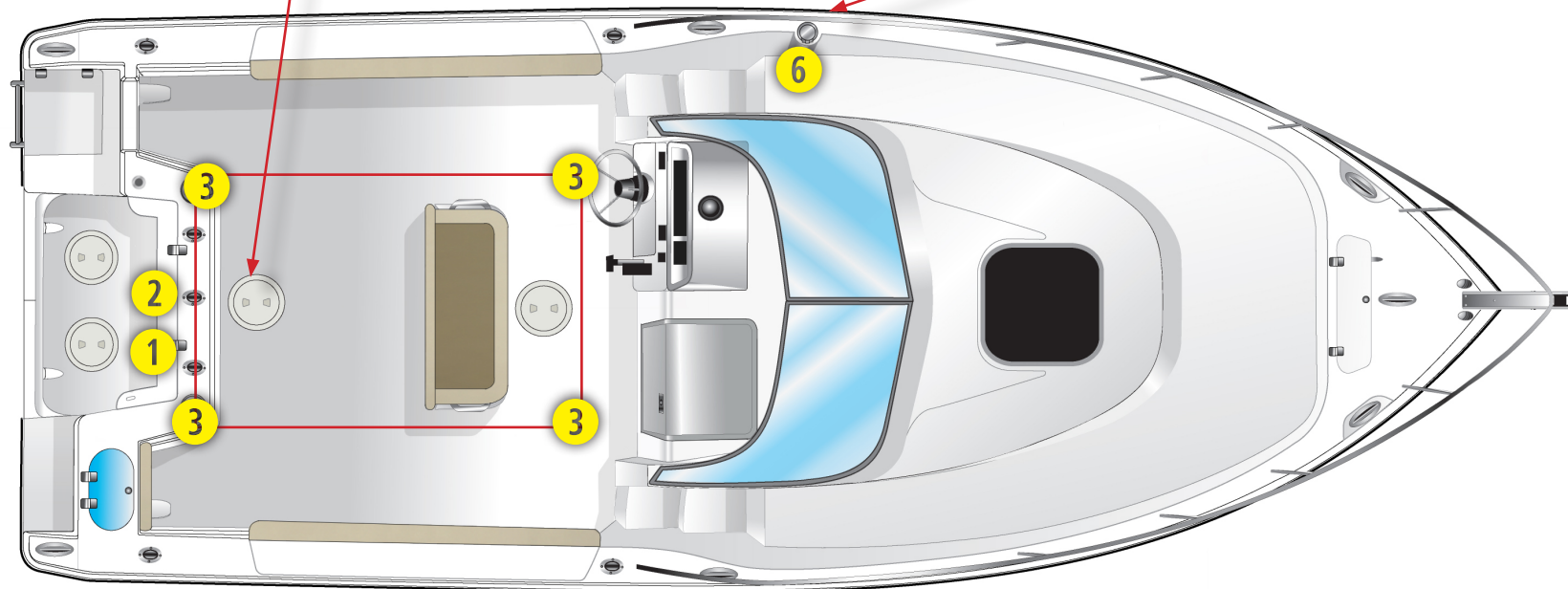

Plumbing Diagram - 220 WAC



07/13/2020

220 WAC Sailfish

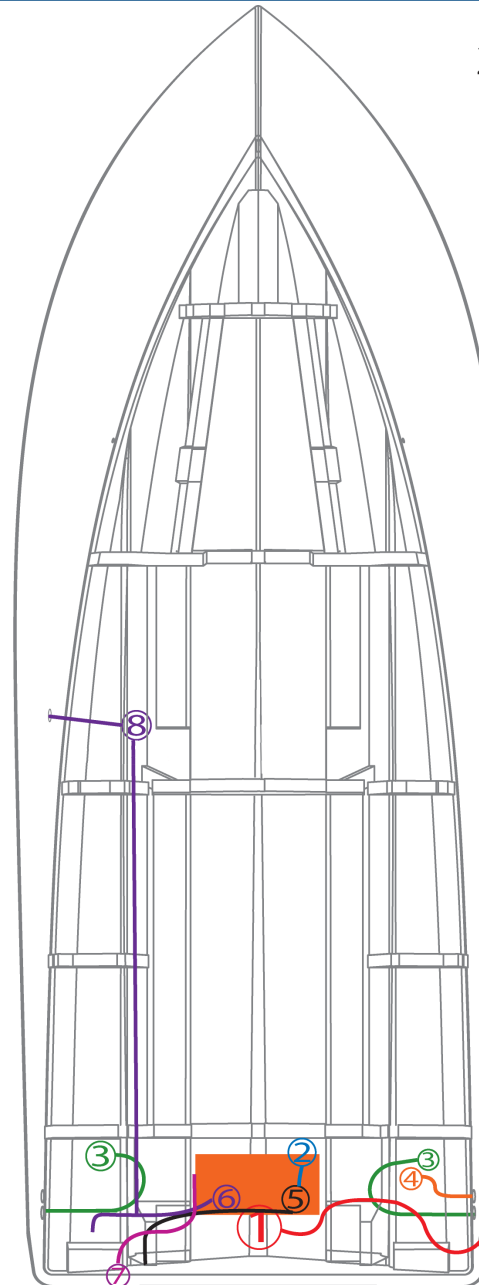

1. Bilge Pump

2. Livewell Fill Pump

3. Deck Drain

4. Livewell Drain

5. Transom Washdown Pump

6. Fresh Water Pump

7. Fresh Water Fill and Vent

8. Fresh Water sink

Helm Area



07/13/2020

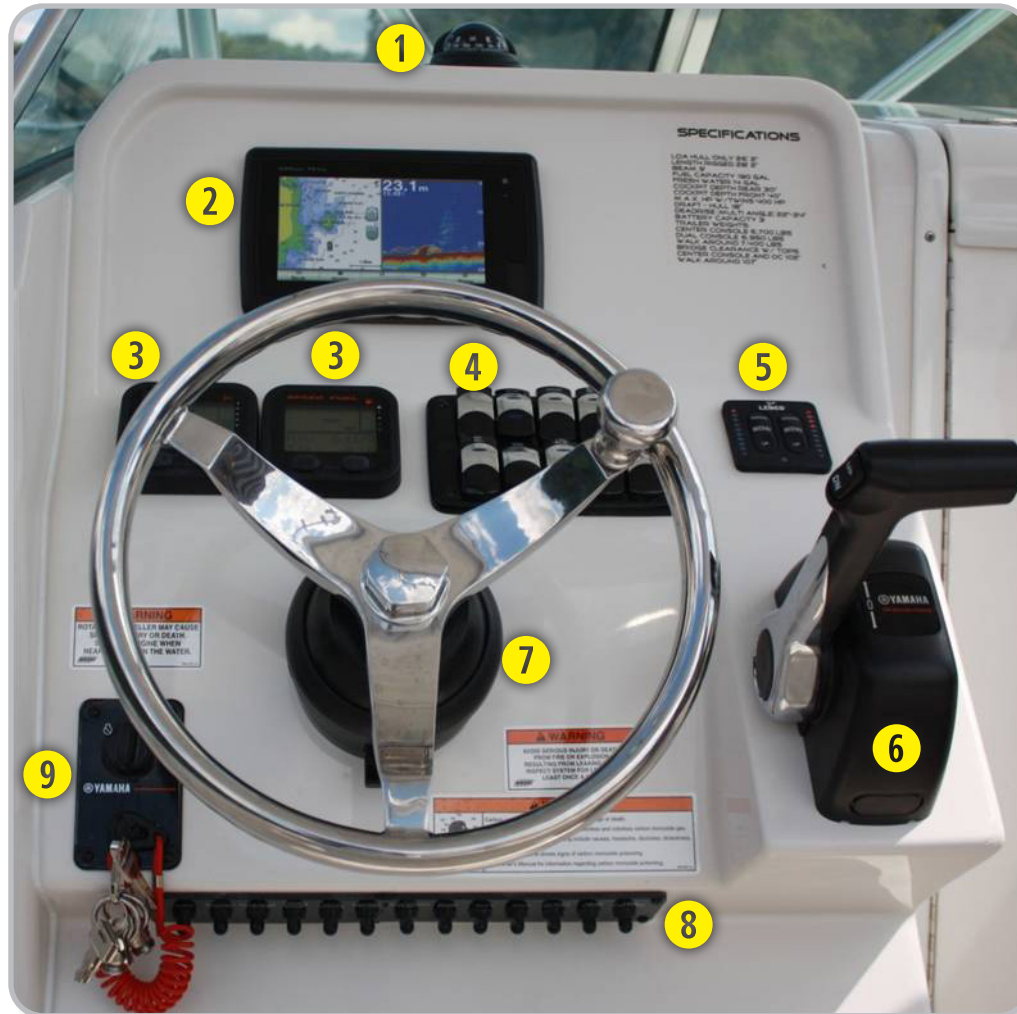

Key	Description
1	Compass
2	Optional Garmin Unit
3	Brand Specific Motor Guages
4	Switch Panel
5	Trim Tab Actuator Switches
6	Binnacle
7	Tilt Helm w/ Stainless Wheel and Power Knob
8	Breaker Panel
9	Ignition Switches and Emergency Shut-off Cord



UFLEX Steering System

UFLEX has been the choice for steering for Sailfish boats for the last three years because of the quality of the USA built products.

Every helm comes standard with a full stainless steel shaft; cylinders are built with carbon steel pistons, coupled with extra-large end caps to prevent leakage.

All of their connection materials are 304 stainless steel that has been electro-polished and passivated.

For more information on the service and maintenance of your UFLEX system please refer to your UFLEX owner's manual or view it electronically at http://uflexusa.ultraflexgroup.com/public/File/UFLEX2013_USA.pdf

Ignition Switches, Engine Shut-off Cord/Lanyard

Each Sailfish boat will be equipped with a Yamaha or Mercury ignition switch with an emergency engine shut off cord/lanyard.

This lanyard should be worn at all times while operating the vessel, if the vessel operator falls or moves a unsafe distance away from the helm controls the lanyard will pull out causing the engine to shut down.

Make sure the lanyard is not attached to a part of your clothing that could be easily torn free causing the switch not to pull. See your YAMAHA or MERCURY owner's manual for more information on this safety feature.

Engine Break-In Period

Each new outboard motor will need to go through a break in period to make sure all of the internal moving parts and components have a chance to correctly mate.

For more information on the break in period specific to your engine please refer to your YAMAHA or MERCURY Owner's manual.

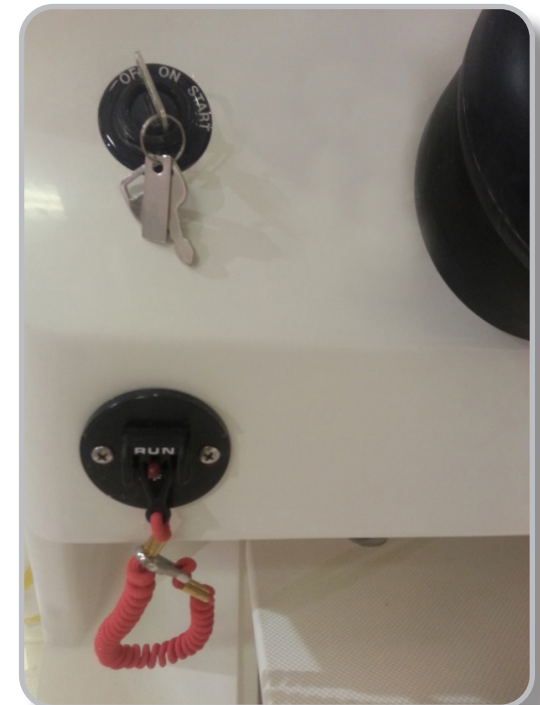

Plug and Play Wiring

Deutsch Connectors are quick disconnect plugs used for durability and ease of replacing components in your Sailfish Boat.

These water resistant plugs are for use in electrical systems where moisture, salt spray, dirt and dust could affect the electrical connections or systems.



Fuel-Water Separator

Sailfish has rigged either Yamaha or Mercury, (Verado Only), water fuel separators in the bilge compartment. Each engine will have its own filter. These filters can be accessed through the bilge access doors, in the back of the boat. For more information on these filters, please review your Yamaha or Mercury Owner's Manuals.

Console/Head Area



07/13/2020



Key	Description
1	Large panel for easy access to Console Components
2	Portable Stove
3	Freshwater Sink
4	Cooler Storage
5	Cabin Door
6	Standard Stereo
7	Optional Porta Potti

Bilge Access and Explanation

The bilge of your boat can be accessed through the large door in the aft of the boat. This large door allows easy access too many of the boats components.

You may also access it through the two access plates in the splash-well.

The bilge area of your sailfish boat should be checked before, during and after each operation.

A small amount of water in this area is normal but large amount of water could point to a major issue such as a leak. If this situation presents itself please contact your Authorized Sailfish Dealer Immediately.

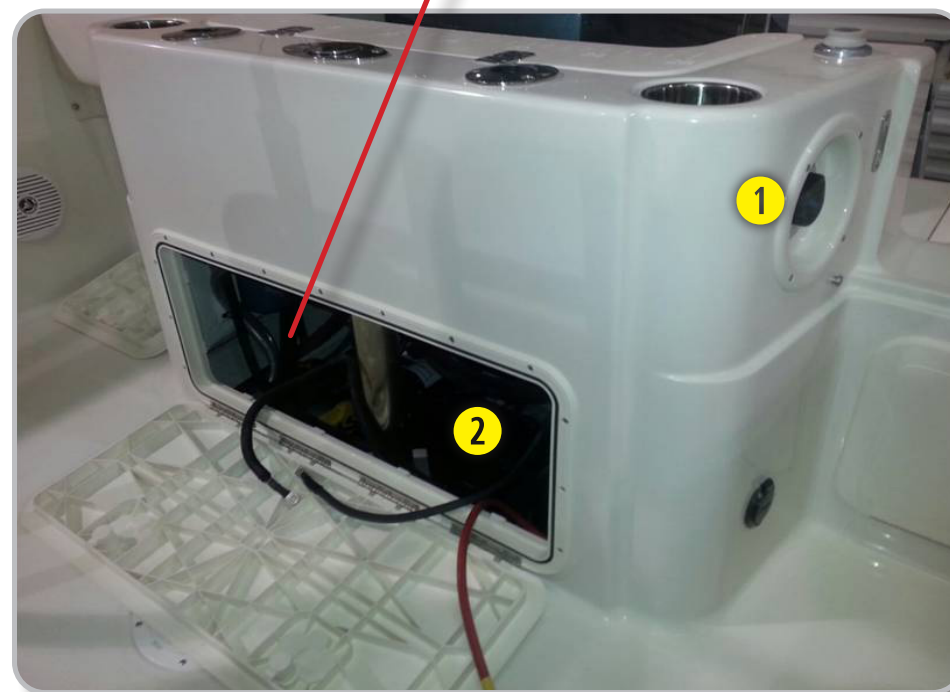

Key	Description
1	Recessed Battery Selector Switch
2	Battery Storage

Bilge Pumps

All Sailfish Boats are furnished with Rule Bilge Pumps, The Rule 2000 GPH (gallon per hour) pump has a built in automatic float switch. This is engaged when the water level rises in the bilge and the float rises in the pump causing the pump to turn on.

These pumps can be tested by turning them upside down, the pump should turn on, once turned back over it will run for a few more seconds and then shut off. The pumps also have a manual switch function on the main switch panel.

These pumps are wired into your boat bypassing the battery switch so that they have power at all times, this allows the automatic feature to work while you are away from the boat and the batteries are turned off.

Sailfish boats 241CC and larger are equipped with a forward bilge pump that is an electronic sensor pump. These pumps have a state of the art internal water sensor that detects water and automatically activates the pump when there is enough present to be pumped out.

These pumps can be tested by placing your finger over the "Test Area" on the back of the pump for 5 seconds, the pump will turn on to let you know it is functioning correctly. All wiring and switches to these pumps are the same as the Rule 2000GPH pumps.



Raw water Washdown system

The raw water wash down on your Sailfish Boat is powered by a Shur-flo Pro Blaster Pump which creates a pressurized system, once the pump is turned on and pressure is created the pump will shut down until more pressure is needed. The raw water wash down pump can be accessed through the bilge access door in the aft of the boat.

To operate make sure the seacock is in the open position. The hose fitting for the wash down is located in the transom splash well, to use simply attach a hose with a nozzle and turn the switch on. Pressure will build up in the hose and the nozzle and as you spray the pump will continue to engage as needed.

Key	Description
1	Raw Water Washdown Hose Fitting



Freshwater Washdown and Shower System

The freshwater washdown and shower system on your Sailfish Boat is powered by a Shur-flo Pro Blaster Pump which creates a pressurized system, once the pump is turned on and pressure is created throughout the freshwater hoses; once they are all pressurized the pump will shut down until more pressure is needed.

All of the freshwater systems on the boat will operate on this system once the freshwater switch is engaged.

You should allow a few seconds for the system to prime and pressurize before attempting to use any of the showers/sinks ect.

The freshwater holding tank is located behind the fuel tank in the bilge area.

The fill for this tank is located under the cutting/measuring board on the port side of the vessel. The freshwater pump can be accessed through the bilge access door in the aft of the vessel.



Key	Description
1	Freshwater Fill
2	Freshwater Shower

Livewell Operation



07/13/2020

Instructions

- Make sure the seacock below the baitwell pump is in the open position.
- Turn on the livewell switch.
- Adjust the black aerator in the livewell to the desired flow (shown in CLOSED picture).
- In order to fill the livewell, place the white stand pipe with the strainer into the center drain hole.
- To drain the livewell remove the stand pipe and the water will flow out the drain hole.



Trim Tab Maintenance Tips



07/13/2020

Cleaning

The attractive surface appearance of stainless steel cannot be regarded as completely maintenance-free. Our 304 Series Stainless Steel may in fact stain, discolor, or accumulate a layer of surface contamination (dirt and grime) during the normal course of the life cycle.

Minute particles of dust and rust may adhere to the stainless steel during shipping, installation or storage at OEM or retail locations.

Also, please remember that some types of stainless steel fasteners tend to “bleed” over the tabs and onto the boat. To achieve maximum corrosion resistance, the surface of the stainless steel must be kept clean and free of all these contaminants.

NOTE: Lenco RECOMMENDS AN ACID AND WATER SOLUTION TO CLEAN THE TRIM TAB BLADES. MARYKATE'S ON & OFF PRODUCT IS A GOOD CHOICE. RINSE THOROUGHLY UPON COMPLETION. BIODEGRADABLE, BUT PLEASE FOLLOW THE MANUFACTURER'S INSTRUCTIONS BEFORE APPLYING.

Sacrificial Anodes for your Lenco SS Trim Tabs

Be aware that stray currents in your marina or in a visiting marina can cause damage to your trim tab blades if not protected by sacrificial anodes.

- The addition of anodes on each tab will deter electrolysis.
- Do not paint under the anode or the anode itself.
- Check Anode condition frequently. Replace when necessary.

Visual inspection of system

- Periodically inspect all wires, mounting brackets, and hardware for damage.
- Make sure all mounting brackets are secure and working properly.
- Periodically test system for smooth operation.



Prepare Unit

- Separate tanks (Fig. 1A & 1B).
- Add Deodorant (Fig. 2A & 2B) and 4-oz of water.
- Close valve (Fig. 2C).
- Recombine Tanks (Fig. 3)
- Fill upper tank with fresh water (Fig.4). Replace cap and tighten securely.

NEVER add deodorant to fresh water tank.

Before Use

Vent any built-up heat or altitude pressure and prevent splashing: close cover (Fig. 5A), and open and close holding tank valve (Fig. 5B).

To Flush

- Open Valve (Fig. 2A).
- Bellows: Fig. 6.
- Piston Pump: Fig. 7.
- Electric Flush: Fig. 8 For best rinse and efficient water use, press button quickly several times.
- Close valve completely for odor-tight seal (Fig. 2C).

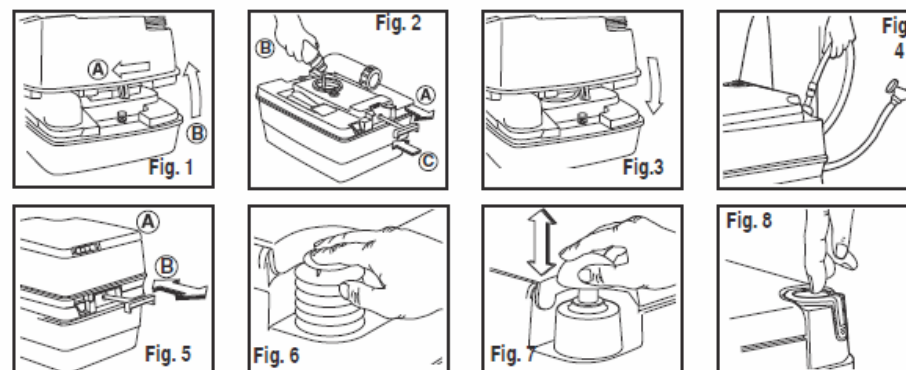

Deodorizing

Recommended holding tank deodorant for best performance:

Thetford SupremeGreen
Thetford Aqua-Kem
Thetford Campa-Chem



Care

Recommended cleaner:
Thetford Aqua-Clean

NEVER use scouring powders, acids or concentrated cleaners, which can damage plastic parts and rubber seals.



Service & Parts

For parts and/or service, contact your RV Dealer.

For warranty issues or more information, call Thetford's Customer Relations Department:
1-800-521-3032.

Emptying Waste Tank

1. DO NOT OVERFILL TANK. Empty when waste level indicator turns from green to red (Fig. 9). (Toilet without an indicator: open valve to check visually).
2. Be sure valve handle is closed. Separate tanks (Fig. 10).
3. Carry waste tank to a permanent toilet.
4. Remove Pour-Out Spout Cap while it is pointing upward (Fig. 11).
5. Press Air relief valve to prevent splashing (Fig. 12).
6. Rinse, recharge and reassemble unit.

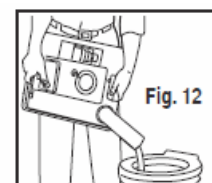
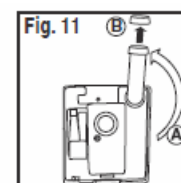
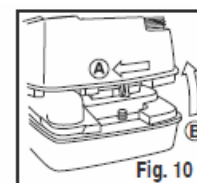
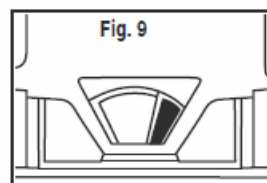

Deodorizing

Recommended holding tank deodorant for best performance:

Thetford SupremeGreen
Thetford Aqua-Kem
Thetford Campa-Chem



Care

Recommended cleaner:
Thetford Aqua-Clean

NEVER use scouring powders, acids or concentrated cleaners, which can damage plastic parts and rubber seals.



Service & Parts

For parts and/or service, contact your RV Dealer.

For warranty issues or more information, call Thetford's Customer Relations Department:
1-800-521-3032.

Vinyl Care and Cleaning



07/13/2020

Step-by-Step Cleaning Instructions

Type of Stain	Steps:	1	2	3
General Care		A	B	
Dirt Build-Up		A	B	
Ballpoint Ink*		E	B	A
Chewing Gum		D	A	
Coffee, Tea, Chocolate		B		
Grease		D	B	
Household Soil		A	B	
Ketchup		A	B	
Latex Paint		A	B	
Lipstick		A	B	
Mildew or Wet Leaves*		C	B	A
Motor Oil		B		
Oil-Based Paint		D	B	
Permanent Marker*		E	B	C
Spray Paint		B		
Suntan Lotion		A	B	
Tar / Asphalt		D	B	
Yellow Mustard		A	B	C

Legend

A. Medium-Soft brush, warm soapy water, Rinse / Dry

B. Vinyl Finish Vinyl Cleaner®, Rinse / Dry

C. One (1) tablespoon of ammonia; one-fourth (1/4) cup of Hydrogen Peroxide, three-fourth (3/4) cup of water, Rinse / Dry

D. Wipe or scrape off excess (chill gum with ice before hand)

E. Hemisphere Ink Remover, Rinse / Dry

Failure to care for your vinyl properly, or use of improper cleaners may void your warranty & damage your vinyl.

Do's & Don'ts

Do's

- Vinyl Finish Vinyl Cleaner
- Dish Soap (Dawn, Ivory)
- Fantastik
- 303 Aerospace Protectant

Don'ts

- Formula 409
- Murphy's Oil Soap
- Simple Green
- Armor All
- Son-of-a-Gun
- Turtle Wax / Tar Remover

All cleaning methods must be followed by a thorough rinse with clean warm water.

Certain household cleaners, powdered abrasives, steel wool, and industrial cleaners can cause damage and discoloration and are not recommended. Dry cleaning fluids and lacquer solvents should not be used as they will remove printed pattern and gloss. Waxes should be used with caution as many contain dyes or solvents that can permanently damage the protective coating. *Suntan lotion, tree pollen, wet leaves, and some other products can contain dyes that stain permanently.

***Always Remove Stains Immediately!**

Caring for Aluminum – Cosmetic Corrosion (Pitting)



07/13/2020

The information provided is designed to give you a thorough understanding of the factors that can impact the appearance of your anodized aluminum. By using this information, we hope to help you enhance the beauty and value of our products.

What Causes It?

Corrosion is a natural phenomenon that affects metals by either a chemical or electrochemical reaction. The rate at which aluminum corrodes depends greatly on the environmental conditions and the amount of preventative maintenance performed. Our goal is to slow down or stop this natural phenomenon we call pitting (or corrosion).

Anodized Aluminum

The aluminum on your boat has been anodized. This creates a very hard protective seal on the surface of the aluminum to protect it as much as possible from pitting. When the anodized coating is broken and raw aluminum is exposed, corrosion will take place. Damage from other abrasive impacts can break the anodized coating.

Chemical Attack

Corrosive chemicals containing high concentrations of acids or alkalis will remove the anodized coating. Solutions containing chlorine, salts,

or ammonia are all harmful to the anodized aluminum on your boat. Many common household cleaners contain chemicals that will remove the anodizing and cause pitting.

Available	Unavoidable
Strong acidic solutions found in cleaners, paint remover, degreasers, etc.	Airborne pollution. Airborne particles from local sources: vehicles, incinerators, paper mills, chemical plants, power plants, etc.
Concentrated alkaline based solutions. Many concentrated soaps fall into this category.	Harsh chemicals from work performed at local shipyards and dry docks.
Chlorine, sulfurs, solvents and ammonia based products.	Be aware of local sources that can expose your new boat to corrosive chemicals.



Caring for Aluminum



07/13/2020

Tips

Avoid the use of bleach or chlorides to clean the aluminum or nearby components. Chlorides can leach onto the aluminum when used nearby.

Avoid abrasive cleaning products. Never use steel or brass wool, wire brushes, polishing wheels, rubbing or polishing compounds. These items will remove the anodizing and lead to pitting.

Protective Products

There are many different products available to protect aluminum. Some are designed to seal and protect before problems occur and others are designed to use after pitting has appeared.

While these products are effective, they are not one time solutions. Metal protectors must be reapplied on a regular basis. How often a protector should be used varies according to the protector you choose, the types of exposure your boat is subjected to, and how often you use and wash your boat. Follow the application guidelines provided with the protector you choose.

Harmful Cleaners

Bleach (Chlorox, etc.)

Mild abrasive cleaners (Ajax, Comet, Soft Scrub, Rubbing Compounds, etc.)

Strong cleaners (409, Engine Degreasers, Bilge Cleaners, Teak Cleaners, Bottom Cleaners, etc.)



Below are some metal protection products that are readily available at marine retailers.

Woody Wax CPR	Woody Wax woody-wax.com 800-619-4363
Boeshield T-9	PMS Products, Inc. boeshield.com 800-962-1732
Premier Polish	Aquatech aquatech-marine.com 800-853-7760
Corrosion Block	Lear Chemical learchem.com 800-256-2548

Caring for Stainless Steel



07/13/2020

The information provided is designed to give you a thorough understanding of the factors that can impact the appearance of your anodized aluminum. By using this information, we hope to help you enhance the beauty and value to our products.

What Makes Stainless Steel Stainless?

Oxygen is the key element in causing rust, or red oxide on steel and other metals. Stainless Steel contains Chromium which reacts with the oxygen in the air to form a chrome-oxide surface layer that is invisible to the eye, but strong enough to prevent further oxygen from “staining” (rusting) the surface. Higher levels of Chromium and the addition of other alloying elements such as nickel and molybdenum enhance this surface layer and improve the corrosion resistance of the stainless material.

What Determines Different Grades of Stainless Steel?

The grade of Stainless Steel is primarily determined by the amount of the Chromium and Nickel alloys contained in the material. 304 and 316 are the prominent grades of Stainless Steel: 304 contains 1% Chromium and 8% Nickel, while 316 contains 16% Chromium and 10% Nickel and 2% Molybdenum. The Molybdenum is added to help

resist corrosion to chlorides (like sea water and de-icing salts).

Can Stainless Steel rust?

Not in the way steel rusts. Steel will discolor, bubble and flake from red oxide development. Stainless Steel may develop red spots, but this is usually due to Iron particles on the surface of the Stainless Steel. Any Iron particles must be removed and the Stainless Steel cleaned with a high concentration of citric acid or a commercial cleaner specifically designed for Stainless Steel.

Is Stainless Steel Green (Environmentally Friendly)?

Stainless Steel is highly sought after by recyclers and is 100% recyclable. New Stainless Steel typically has a recycled content of between 65% & 80% which makes it one of the highest average content recycled construction materials on the planet.

Will Stainless Steel Discolor?

Cleaners that are typically used with cement, grout and stone, etc., may contain Muriatic Acid.

Stainless Steel is not resistant to Muriatic Acid. MURIATIC ACID SHOULD NOT BE USED IF STAINLESS STEEL IS PRESENT. It is not even necessary that the acid touch the Stainless Steel, just the “fumes” from it will cause a discoloration of the Stainless Steel. Other than this, Stainless Steel is usually very resistant to discoloring.

Regular cleaning with fresh water and a soft cloth will keep and protect your windshield, window, or hatch for years.

GLASS

Use commercially available glass cleaners or a mixture of fresh water and vinegar. Do not use abrasives, harsh chemicals, or metal scrapers. Regular cleaning will help assure clarity of the glass for safe boating.

PLASTIC TYPE WINDSHIELDS

Never use glass cleaning solutions or dry cloth to clean Plexiglas. Never use acetone, benzene, carbon tetrachloride, or lacquer thinner. The only acceptable cleaners are a small amount of denatured alcohol, clean water, or a commercially available plastic polisher specific for the purpose. Use a soft rag and wash off the plastic windshield first with lukewarm water to avoid scratching the surface.

WINDOW CHANNELS

Clean window channels with mild detergent only. Channels can be sprayed with silicon aerosol while sliding the glass back and forth.

STAINLESS STEEL

Polish with commercially available metal polishes. A boat or car wax periodically applied will offer extra protection against the elements.

PAINTED SURFACES

Clean with fresh water periodically. Touch up scratches and areas where paint has chipped off with touch-up spray paint. Touch up kits are available from the factory. Boat top clips – never slide along windshield framework.

To change clip location, snap on and off the aluminum top track.

SIDE WING VENT ADJUSTERS

Use care when opening and closing vent. Do not force.

Never ground windshield with any electrical devices or appliances.

Never use the windshield as a mooring cleat for tying off to a dock, pier or another boat. Never use the windshield as a tie-off attachment for trailering purposes.



Your Boat's Gel Coat Finish

Congratulations! You are the proud owner of a new power or sail boat. You are also the owner of a new Integrity® gel coat finish on the hull and/or topside, and we would like you to be as proud of it as we are. That beautiful, shiny new color you love is the result of many years of gel coat research, testing and development.

But as proud as we are of the gel coat, no finish is totally impervious to chemicals and weathering. Imagine what a brand new car could look like if allowed to sit at a marina for years with no cover and no washing or waxing. With the same minimum maintenance you would ordinarily give your new automobile's finish, your boat's gel coat finish will retain its depth of color and gloss for years.

Overall Maintenance

Normal maintenance of your gel coated fiberglass boat is similar to the care you would give your automobile. Overall, automotive cleaners and waxes work fine, as well as the marine cleaners and waxes.

Note: Do not use caustic or highly alkaline (high pH) cleaners or those containing ammonia. These type of cleaners may darken white or off-white weathered gel coat surfaces. A chemical reaction

producing staining occurs if these type of cleaners are used on weathered gel coat. However, the stain may be removed with a rubbing compound or by lightly sanding with 400 grit sandpaper followed by an application of rubbing compound and a thorough waxing.

Cleaning

We recommend general washing to avoid soil build-up and staining. The soil to your gel coat is the result of regular use and environmental pollutants such as soot and smog. Periodic cleaning with a mild detergent is necessary to remove normal deposits of soil.

Waxing

From constant exposure over time to our natural environment and undesired pollutants, the gel coat begins to lose its gloss. To restore your finish to the original gloss and color requires your special attention. After washing with a mild soap or detergent, give the surface a good polishing with a self-cleaning marine or automotive wax. Waxing in the fall and spring is generally recommended to maintain and restore most of the original gloss. If the surface has not been maintained and has weathered badly, and if cleaning and waxing does not restore the finish satisfactorily, compounding will be required.

Compounding

Please see your marine dealer for advice. Polishing and compound (fine abrasive) or rubbing compound (coarser abrasive) is recommended for use on fiberglass boats to remove scratches, stains, or a severely weathered surface. Polishing or rubbing compound can be applied by hand or by pneumatic buffer. After the scratched, stained or weathered surface has been moved, it should be waxed to enhance the gloss and color while providing a seal to retard staining or new soil accumulation.

Discoloration Removal

Your marine dealer is best equipped and trained to do this work. If regular washing and waxing has been neglected, discoloration of the gel coated fiberglass surface may occur.

Discolored areas are very shallow in depth, literally right on the surface. The discoloration may be removed by gently wet-sanding the affected areas only by using 600 grit, wet or dry specially treated waterproof sandpaper. It's important to always sand in one direction, this includes the curves too. Use plenty of water to cool and clean the sandpaper and cut back on dust. After you are finished sanding, dry the areas and verify all the discoloration has been removed. If not, repeat the process.

After all the discoloration has been removed, the area will need to be buffed. Using an electrical or pneumatic buffer, buff at low speed (1750 rpm – 2250 rpm), this will restore the luster to the sanded surface. Using a generous amount of rubbing compound, apply it in a circular motion with a soft wool pad. When buffing has been completed, wash off the rubbing compound with clean water, and dry the surface.

To restore the gloss to the affected area, use a high-grade marine or automotive wax.

Repairs

During the life of your boat, some damage to the gel coat surface is unavoidable. We recommend repairs done by trained, experienced professionals at your local marine dealer.

Scratches

If the scratch is in the gel coat surface, not penetrating the fiberglass, use an automotive polishing compound and rub it out. Apply the compound by hand using a damp rag or by using a power buffer. The scratch may not entirely disappear, but it should be noticeably better.

Gouges and Chips

Our recommended patching procedure is to first clean the area needing repair with an acetone solvent to remove all traces of wax and oil. Next, thoroughly mix one tablespoon of "Patch Paste" with two or three drops of catalyst on a scrap piece of cardboard.

Apply the mixture to the pit, chip or gouge with a single-edge razor blade, matching the surface and contour of the area being repaired. Apply slightly more mixture to avoid having to fill the damaged section a second time. Allow the patch to harden thoroughly for a minimum of two to three hours.

Using a fine grit "wet or dry" sandpaper on a sanding block, wet-sand the patch until it is level with the surrounding surface. Finish with a marine or automotive rubbing compound using the same approach as used for the scratches.

Refinishing

For a severely scratched or weathered fiberglass boat that is no longer restorable by using the previous methods, it may then be necessary to refinish it with two-package or two-part aliphatic urethane enamel. This can be done very effectively, but it is recommended refinishing should only be done by experienced professionals.

